



Deltek

# Deltek Costpoint Cloud

SFT Integration Setup Guide

November 8, 2022



---

While Deltek has attempted to verify that the information in this document is accurate and complete, some typographical or technical errors may exist. The recipient of this document is solely responsible for all decisions relating to or use of the information provided herein.

The information contained in this publication is effective as of the publication date below and is subject to change without notice.

This publication contains proprietary information that is protected by copyright. All rights are reserved. No part of this document may be reproduced or transmitted in any form or by any means, electronic or mechanical, or translated into another language, without the prior written consent of Deltek, Inc.

This edition published November 2022.

© Deltek, Inc.

Deltek's software is also protected by copyright law and constitutes valuable confidential and proprietary information of Deltek, Inc. and its licensors. The Deltek software, and all related documentation, is provided for use only in accordance with the terms of the license agreement. Unauthorized reproduction or distribution of the program or any portion thereof could result in severe civil or criminal penalties.

All trademarks are the property of their respective owners.



---

# Contents

Overview .....	1
Step 1: Configure SFT and Costpoint for Integration.....	2
Step 2: Configure Firewall for Inbound Connections .....	3
Step 3: Submit a Deltek Costpoint Cloud Service Request.....	4

## Overview

The Costpoint 8 Shop Floor Time Integration automates the flow of data between systems using SOAP web services.

There are three steps to implement the Shop Floor Time integration with Costpoint GovCon Cloud systems:

- Step 1: Configure SFT and Costpoint for Integration
- Step 2: Configure Firewall for Inbound Connections
- Step 3: Submit a Deltek Costpoint Cloud Service Request

**Attention:** Contact [Deltek Customer Care](#) or your account team to obtain consulting assistance.

## Step 1: Configure SFT and Costpoint for Integration

Refer to the [Deltek Costpoint PMFG Integration to SFT 2.1 and MES 2.0](#) for detailed instructions.

## Step 2: Configure Firewall for Inbound Connections

The connection from your Costpoint GovCon Cloud system to your SFT web service requires allowing inbound TCP Port 443 SOAP connections from Deltek's cloud IP addresses to the network on which the SFT application is deployed.

Open a case with Deltek Customer Care to obtain the list of IP addresses to be allowed.

## Step 3: Submit a Deltek Costpoint Cloud Service Request

See your cloud offering help pages for information about submitting service requests. Please contact your Customer Success Manager if you need assistance with these requests.

- [Costpoint Enterprise GCC Moderate SaaS Administrator Service Requests - KB 102974](#)
- [Costpoint Enterprise GCC Standard SaaS Administrator Service Requests - KB 88571](#)
- [Costpoint GCC Moderate SaaS Administrator Service Requests - KB 102977](#)
- [Costpoint GCC Standard SaaS Administrator Service Requests - KB 76128](#)

You must submit a separate request for each Costpoint/SFT system pair (for example, Costpoint Production and SFT Production).

### To submit a SFT Integration service request:

1. Log into the [Deltek Support Center](#) and navigate to [Cloud Solutions](#).

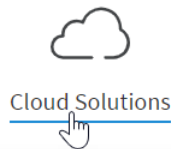

2. Select your Cloud Product, and click **Go**.

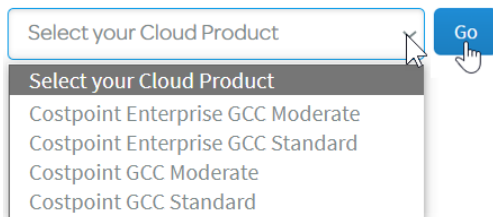

3. From the **SERVICE REQUESTS** list, select **Costpoint GCC Integration Setup**.

Please note that the name of the service request is different for each cloud product:

- For Costpoint Enterprise GCC Moderate, select **Setup Integration with Costpoint**.

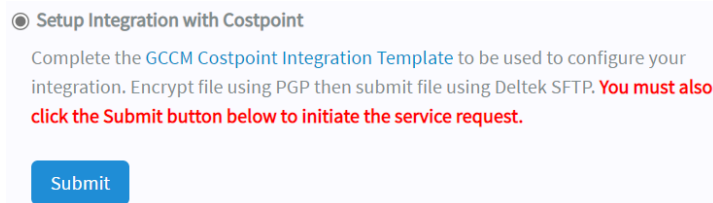

### Step 3: Submit a Deltek Costpoint Cloud Service Request

- For Costpoint Enterprise GCC Standard, select **Costpoint Enterprise GCC Standard Integration Setup**.

● Costpoint Enterprise GCC Standard Integration Setup

Attach the [Costpoint Integration Configuration Template](#) to be used to configure your integration.

Costpoint Enterprise GCC Standard Integration Template:

SFT\_67725\_20221031.xlsx

Additional Instructions (Domain Names):

Update only specified systems.

4. Download and unzip the CostpointIntegrationConfigurationTemplates.zip file.
5. Complete the Shop Floor Time integration spreadsheet (ShopFloorTime.xlsx).  
Detailed instructions for completing the spreadsheet are included in the spreadsheet itself.
6. Save and rename the completed spreadsheet to include your Company ID and the date submitted.
7. Upload the completed SFT\_CompanyID\_Date.xlsx spreadsheet.
  - **GCC Standard** customers upload their spreadsheet directly in the service request widget. Upload the spreadsheet now and click **Submit** to open a new case for this request.
  - **GCC Moderate** customers must encrypt and upload the spreadsheet using Deltek SFTP. Click **Submit** now to create a new case for this request, and then use the following instructions to perform the encryption and upload the file:
    - [Encrypting a File to Send to Deltek](#)
    - [Uploading Files to the Deltek SFTP Service \(GoAnywhere\)](#)





---

## About Deltek

Better software means better projects. Deltek delivers software and information solutions that enable superior levels of project intelligence, management, and collaboration. Our industry-focused expertise makes your projects successful and helps you achieve performance that maximizes productivity and revenue. [www.deltek.com](http://www.deltek.com)